



Shackle Load Cell

SHK-B

Features

- Ranges 50 ton (500 kN) to 500 ton (5000 kN)
- High Tensile Carbon Steel Construction
- Environmentally Sealed to IP65
- (IP67 can also be offered)
- Simple installation and operation
- Shackle and load pin fully certified
- Optional load centralising bobbin
- Stainless Steel load pin option available
- Can be supplied with amplified output
- Armoured rubber hose protected cable



Description

The range of Shackle Load Cells is designed for lifting and weighing in rugged or harsh environments.

The shackle pins are forged from high tensile carbon steel and are machined to an exacting specification.

This range of load cells is Proof Loaded to 150% of the normal rated load.

The SHK-B series are available in a range from 50 ton to 500 ton.

The integral cable is normally enclosed in an armoured rubber hydraulic hose to give physical and environmental protection.

The SHK-B is internally gauged and the whole instrumented area is sealed to IP65, to protect it in service.

They are simple to install and are available in standard shackle sizes.

As an option, a rotating bobbin can be supplied, to centralise the load and to minimise any point-load effects when the shackle is placed under load.

We are always pleased to discuss any special requirements that can be accommodated.

The SHK-B series can be supplied on it's own or combined with our extensive range of instrumentation to provide a complete load monitoring system.



Shackle Load Cell

SHK-B

Specifications

Rated Load (ton):	50, 100, 200, 250, 300, 400, 500
Proof Load:	150% of Rated Load
Ultimate Breaking Load:	300% of Rated Load
Output:	1.5 mV/V at Rated Load (nominal)
Non-Linearity:	<±1.0% of Rated Load (typically)
Non-Repeatability:	<±0.10% of Rated Load
Excitation Voltage:	10vdc recommended, 15vdc maximum
Bridge Resistance:	350Ω
Insulation Resistance:	>500MΩ @ 500vdc
Operating Temperature Range:	-20 to +70°C
Compensated Temperature Range:	-10 to +50°C
Zero Temperature Coefficient:	<±0.010% of Rated Load/°C
Span Temperature Coefficient:	<±0.010% of Rated Load/°C
Environmental Protection Level:	IP65 (IP67 optional)
Connection Type:	10 metres 4-core screened PUR cable
Wiring Connections:	Red +ve supply Blue -ve supply Green +ve signal Yellow -ve signal
Options Available:	Special ranges available Special electrical connections Integral signal conditioning Lloyd's or other approved witnessed certification

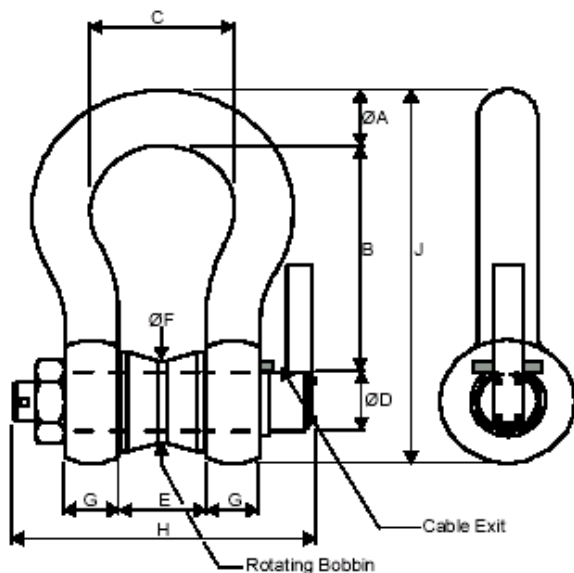

	Part Number/Range						
	SHK-B-50 50 tonne	SHK-B-100 100 tonne	SHK-B-200 200 tonne	SHK-B-250 250 tonne	SHK-B-300 300 tonne	SHK-B-400 400 tonne	SHK-B-500 500 tonne
ØA	65	89	120	125	135	165	175
B	265	370	500	540	600	650	700
C	160	220	290	305	305	325	350
ØD	70	95	130	140	150	175	185
E	105	133	175	200	200	225	250
ØF	90	120	160	175	185	215	230
G	58	80	110	115	120	160	160
H	325	450	610	650	720	800	860
J	440	608	820	880	970	1080	1160
Weight (kg)	45	120	215	275	360	570	715