



## Shackle Load Cell

## SHK-D

### Features

- Ranges 6 ton (60 kN) to 50 ton (500 kN)
- High Tensile Carbon Steel Construction
- Environmentally Sealed to IP65
- (IP67 can also be offered)
- Simple installation and operation
- Shackle and load pin fully certified
- Optional load centralising bobbin
- Stainless Steel load pin option available
- Can be supplied with amplified output
- Armoured rubber hose protected cable

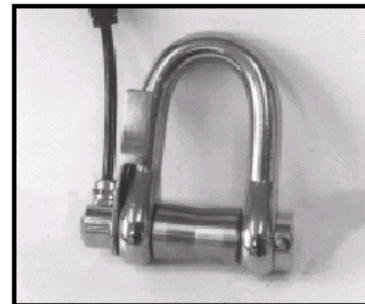

### Description

The range of Shackle Load Cells is designed for lifting and weighing in rugged or harsh environments.

The shackle pins are forged from high tensile carbon steel and are machined to an exacting specification.

This range of load cells is Proof Loaded to 150% of the normal rated load.

The SHK-D series are available in a range from 6 ton to 50 ton.

The integral cable is normally enclosed in an armoured rubber hydraulic hose to give physical and environmental protection.

The SHK-D is internally gauged and the whole instrumented area is sealed to IP65, to protect it in service (hose protection is not available on 6 ton version).

They are simple to install and are available in standard shackle sizes.

As an option, a rotating bobbin can be supplied, to centralise the load and to minimise any point-load effects when the shackle is placed under load.

We are always pleased to discuss any special requirements that can be accommodated.

The SHK-D series can be supplied on it's own or combined with our extensive range of instrumentation to provide a complete load monitoring system.



# Shackle Load Cell

# SHK-D

## Specification

Rated Load (ton):	6, 10, 17, 25, 35, 50
Proof Load:	150% of Rated Load
Ultimate Breaking Load:	300% of Rated Load
Output:	1.5 mV/V at Rated Load (nominal)
Non-Linearity:	<±1.0% of Rated Load (typically)
Non-Repeatability:	<±0.10% of Rated Load
Excitation Voltage:	10vdc recommended, 15vdc maximum
Bridge Resistance:	350Ω
Insulation Resistance:	>500MΩ @ 500vdc
Operating Temperature Range:	-20 to +70°C
Compensated Temperature Range:	-10 to +50°C
Zero Temperature Coefficient:	<±0.010% of Rated Load/°C
Span Temperature Coefficient:	<±0.010% of Rated Load/°C
Environmental Protection Level:	IP65 (IP67 optional)
Connection Type:	10 metres 4-core screened PUR cable
Wiring Connections:	Red +ve supply Blue -ve supply Green +ve signal Yellow -ve signal
Options Available:	Special ranges available Special electrical connections Integral signal conditioning Lloyd's or other approved witnessed certification

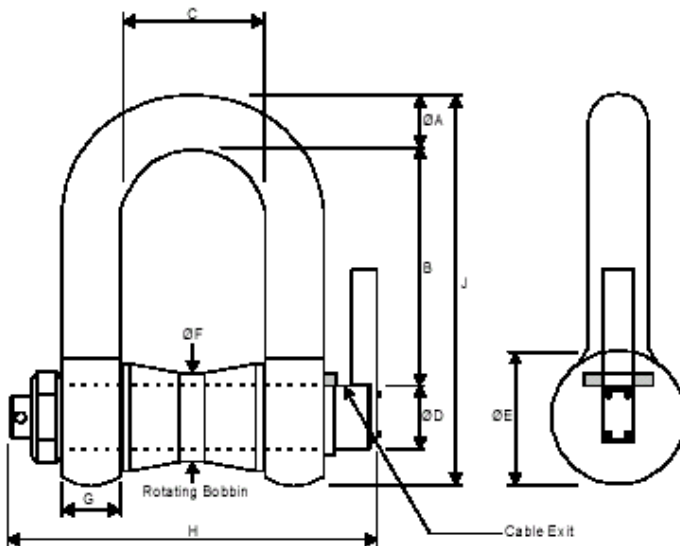

	Part Number/Range					
	SHK-D-6 6 tonne	SHK-D-10 10 tonne	SHK-D-17 17 tonne	SHK-D-25 25 tonne	SHK-D-35 35 tonne	SHK-D-50 50 tonne
ØA	25	32	38	45	51	64
B	75	95	125	150	170	200
C	36	51	60	74	83	105
ØD	29	35	41	51	57	70
ØE	60	76	92	105	127	152
ØF	37	46	54	65	72	90
G	25	32	37	44	50	63
H	111	141	185	222	252	296
J	123	156	206	247	280	329
Weight (kg)	3	6	10	15	22	40